



## Canons Gate, Harlow, CM20 1QF

Geoffrey Matthew Estates are delighted to offer this two bedroom, mid terrace, freehold house in the popular residential location of Canons Gate. Requiring a degree of modernisation throughout, the property is ideally located for access to the Town Centre & Princess Alexandra Hospital. Perfectly suited to a first time buyer or investor, early viewings are highly recommended!

Offers In The Region Of £279,995

# Canons Gate, Harlow, CM20 1QF



- Two Bedrooms
- In Need Of Some Modernisation
- Mid Terrace
- Ideally Located For Town Centre & Hospital
- Freehold
- On Road Parking Only!

## Entrance Hall

## Lounge

18'8 x 9'11 (5.69m x 3.02m)

## Kitchen

21'9 x 6'9 (6.63m x 2.06m)

## First Floor Landing

## Bedroom

10'2 x 12'5 (3.10m x 3.78m)

## Bedroom

11'2 x 9'6 (3.40m x 2.90m)

## Bathroom

8'1 x 5'1 (2.46m x 1.55m)

## Rear Garden

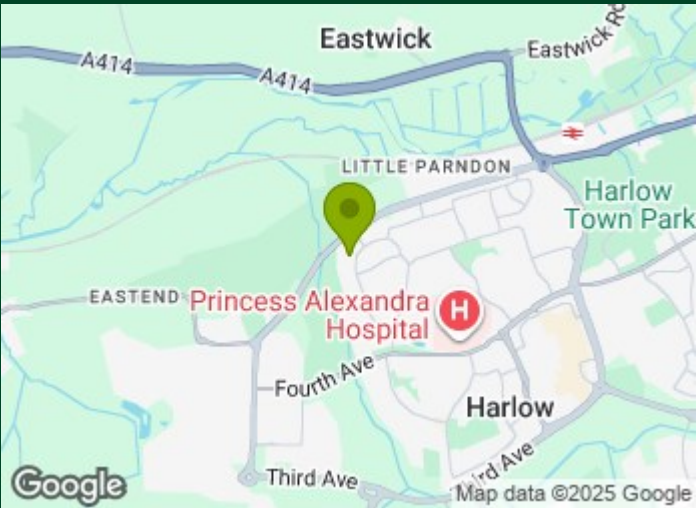

## Directions





## Floor Plan

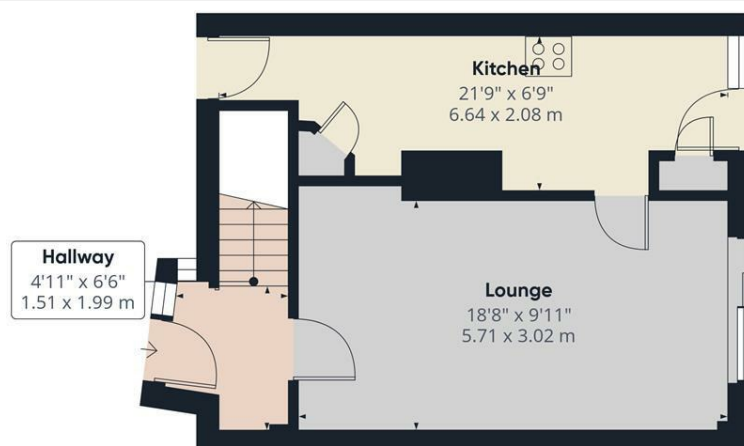

Floor 0

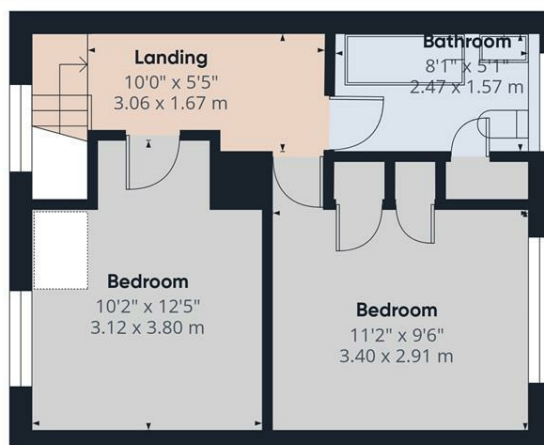

### Floor 1

Approximate total area<sup>m</sup>

703 ft<sup>2</sup>

65.2 m<sup>2</sup>

(1) Excluding balconies and terraces

Calculations reference the RICS IPMS 3C standard. Measurements are approximate and not to scale. This floor plan is intended for illustration only.

GIRAFFE360

## Council Tax Details

## Harlow Band

These particulars, whilst believed to be accurate are set out as a general outline only for guidance and do not constitute any part of an offer or contract. Intending purchasers should not rely on them as statements of representation of fact, but must satisfy themselves by inspection or otherwise as to their accuracy. No person in this firm's employment has the authority to make or give any representation or warranty in respect of the property.

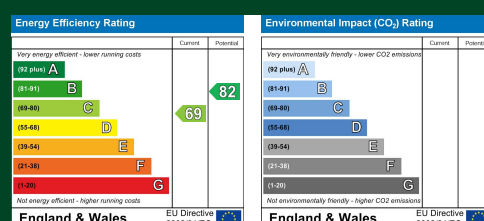

Old Harlow: 01279 444988 Email: [harlow@geoffreymatthew.co.uk](mailto:harlow@geoffreymatthew.co.uk)  
Great Ashby: 01438 740111 Email: [greatashby@geoffreymatthew.co.uk](mailto:greatashby@geoffreymatthew.co.uk)